

Thanks for attending the Northern Kentucky Health Careers Showcase, brought to you by the North Central AHEC. Please review the materials below for more information!

Resources..... 1
Showcase Layout..... 2
Salary List.....3
Gateway2NKU flyer.....4
College and University Matrix.....5

For more information regarding health careers or to reach out to a health professional directly, please email holly.mills@kctcs.edu or rachel.sams@kctcs.edu

Click Here to take our quick 5 question survey

Click here for a brief overview of several health careers including educational requirements and salary

Follow us on Social Media to stay up to date:

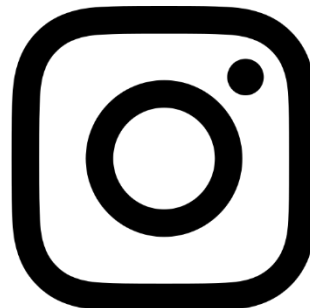

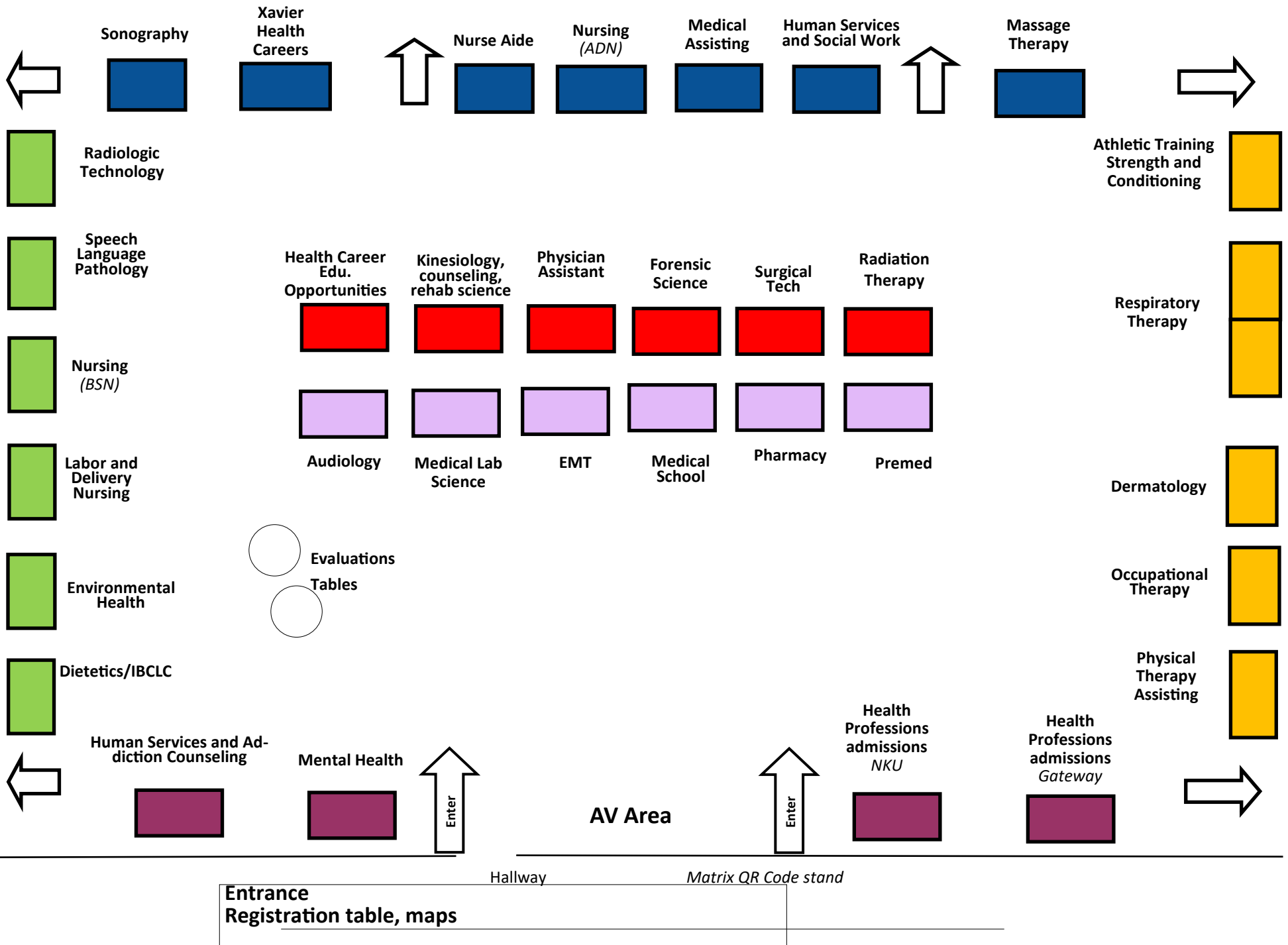

Health Career	Salary	Educational Requirements
Lactation Consultant	\$70,000	certification
Dietician	\$62,050	Masters (6 years)
Dietetic Technician	\$32,100	Associates (2 years)
Massage Therapist	\$44,762	Associates (2 years)
Speech language Pathologist	\$81,660	Masters (6 years)
Respiratory Therapist	\$60,410	Associates or Bachelors (2-4 years)
Atheltic Trainer	\$48,710	Masters (6 years)
Audiologist	\$74,860	Doctorate (8 years)
Physical Therapist	\$86,220	Doctorate (8 years)
Physical Therapy Assistant	\$58,010	Associates (2 years)
Occupational Therapist	\$83,960	Masters or Doctorate (6 to 8 years)
Occupational Therapy assistant	\$66,710	Associates (2 years)
Medical Laboratory Scientist	\$54,000	Bachelors or Masters (4 to 6 years)
Phlebotomist	\$35,760	certification
Medical Laboratory Technician	\$53,010	Associates (2 years)
Medical Assistant	\$34,760	certification or Associates
Health Information technology	\$49,000	Varies from Certification to Masters (1-6 years)
Social Worker	\$45,080	Bachelors or Masters (4 to 6 years)
Psychologist	\$104,190	Masters or Doctorate (6 to 8 years)
Human Services Professional	\$37,000	Associates or Bachelors (2-4 years)
Psychiatrist	\$258,380	Doctorate (8 years)
Pharmacist	\$127,410	Doctorate (8 years)
Pharmacy Technicians	\$35,340	certification or Associates
Optician	\$41,200	certification or Associates
Optometrist	\$152,100	Doctorate (8 years)
Ophthamologist	\$143,510	Doctorate (8 years)
Dental Assistant	\$40,430	Associates (2 years)
Dental Hygienist	\$70,910	Associates or Bachelors (2-4 years)
Dentist	\$188,910	Doctorate (8 years)
Certified Nurse Assistant	\$32,180	Certification
Registered Nurse	\$77,620	Associates or Bachelors (2-4 years)
Advanced Practice Registered Nurse	\$109,290	Masters (6 years)
Health Educator	\$43,800	Bachelors or Masters (4 to 6 years)
Emergency Medical Technician	\$30,940	Certification
Paramedic	\$42,850	Associates (2 years)
Veterinarian	\$105,290	Doctorate (8 years)
Veterinary Technician	\$34,010	Associates or Bachelors (2-4 years)
Surgical Technologist	\$50,030	Associates (2 years)
Physician's Assistant	\$105,980	Masters (6 years)
Physician	\$150,000	Doctorate (8 years)

For More Information about Health Careers, please visit <http://www.northcentralkyahec.org/clusters.html>



TWO DEGREES, ONE PATH

Gateway

- Emergency Medical Services Technology - Paramedic
- Fire Science Technology
- Health Science Technology
- Human Services
- Massage Therapy
- Nurse Aide
- Medical Assisting/Phlebotomy
- Nursing ADN

NKU

- Nursing
- Athletic Training
- Exercise Science
- Health Science
- Human Services and Addictions
- Physical Education
- Radiation Therapy
- Radiologic Science
- Respiratory Care
- Social Work

Pathways

- Exercise Science (AS to BS)
- Health Sciences Degree Completion (AAS in EMT to BS)
- Health Sciences Degree Completion (AAS in MAI to BS)
- Health Sciences Transdisciplinary Track Completion (AA to BS)
- Human Services and Addiction (AAS Human Services to BS)
- Nursing (AAS Nursing to RN to BSN)
- Physical Education (AS to BA)
- Radiation Therapy (AS to BS)
- Radiologic Science (AS to BS)
- Respiratory Care (AS to BS)
- Social Work (AA to BSW)
- Social Work (AAS Human Services to BSW)

Contact gw-transfer@kctcs.edu for more information

Data has been carefully collected to provide the most up-to-date information as possible. Please consult with each college or university before making decisions about higher education. This matrix was last updated June 2025.

● Indicates program is available.

	Bellarmine University www.bellarmine.edu	Berea College www.berea.edu	Brescia University www.brescia.edu	Campbellsville University www.campbellsville.edu	Eastern Kentucky University www.eku.edu	Georgetown College www.georgetowncollege.edu	Kentucky Christian University www.kcu.edu	Kentucky State University www.kysu.edu	Kentucky Wesleyan College www.kwc.edu	Lindsey Wilson College www.lindsey.edu	Midway University www.midway.edu	Morehead State University www.moreheadstate.edu	Murray State University www.murraystate.edu	Northern Kentucky University www.nku.edu	Spalding University www.spalding.edu	Sullivan University www.sullivan.edu	Thomas More University university.thomasmore.edu	Transylvania University www.transy.edu	Union College www.unionky.edu	University of the Cumberland www.ucumberland.edu	University of Kentucky www.uky.edu	University of Louisville www.louisville.edu	University of Pikeville www.upike.edu	Western Kentucky University www.wku.edu	University of Cincinnati www.uc.edu	Xavier University www.xavier.edu	Mount St. Joseph University www.msj.edu	
Athletic Trainer	●													●	●				●		●				●	●	●	
Audiologist																												
Biomedical Engineer																						●	●					
Chiropractor				●																								
Clinical/Medical Lab. Scientist/Tech.	●		●	●													●					●						
Dental Hygienist																												
Dentist																												
Dietitian					●								●									●	●			●		
EMT/ Paramedic					●																	●	●			●		
Environmental Health Scientist	●			●	●									●								●	●			●		
Exercise Physiologist/Scientist	●			●	●				●				●									●	●			●		
Forensic Scientist/Chemist			●		●							●		●								●	●			●		
Healthcare Administrator				●	●						●			●								●	●			●		
Health Information Manager/Tech.					●											●												
Health/Wellness Educator/Specialist	●	●		●	●				●				●									●	●			●		
Human Services Worker			●																									
Mental Health Counselor					●					●			●															
Neuroscience	●				●								●									●	●			●		
Nurse Practitioner/Anesthetist	●				●		●		●				●									●	●			●		●
Nurse, RN	●	●		●	●		●	●		●			●				●					●	●	●		●	●	●
Occupational Therapist					●								●															
Optometrist																												
Pharmacist																												
Pharmacy Technician/Pharmacy Science				●												●												
Physical Therapist	●														●													
Physician																												
Physician Assistant			●										●															
Psychology	●	●	●	●	●			●	●	●		●	●	●	●		●	●	●	●	●	●	●	●	●	●	●	●
Public Health/Scientist/Administrator	●			●	●	●							●				●					●	●			●		
Radiographic Technologist/Sonographer													●			●												
Respiratory Therapist	●												●															
Social Worker			●	●	●		●	●					●	●	●							●	●	●		●	●	●
Speech Language Pathologist			●		●								●									●	●			●	●	●
Sports/Fitness Management/Admin.	●			●	●	●			●		●	●	●		●				●	●		●		●	●	●	●	●

Data has been carefully collected to provide the most up-to-date information as possible. Please consult with each college or university before making decisions about higher education. This was last updated June 2025.

● Indicates that program is available.

	Ashland Community & Technical College www.ashland.kctcs.edu	Big Sandy Community & Technical College www.bigsandy.kctcs.edu	Bluegrass Community & Technical College www.bluegrass.kctcs.edu	Elizabeth town Community & Technical College www.elizabethtown.kctcs.edu	Gateway Community & Technical College www.gateway.kctcs.edu	Hazard Community & Technical College www.hazard.kctcs.edu	Henderson Community College www.henderson.kctcs.edu	Hopkinsville Community College www.hopkinsville.kctcs.edu	Jefferson Community & Technical College www.jefferson.kctcs.edu	Madisonville Community & Technical College www.madisonville.kctcs.edu	Maysville Community & Technical College www.maysville.kctcs.edu	Owensboro Community & Technical College www.owensboro.kctcs.edu	Somerset Community College www.somerset.kctcs.edu	Southcentral Kentucky Community & Technical College www.southcentral.kctcs.edu	Southeast Community & Technical College www.southeast.kctcs.edu	West Kentucky Community & Technical College www.westkentucky.kctcs.edu	Cincinnati State www.cincinnati-state.edu	University of Cincinnati - Blue Ash College www.ucblueash.edu	University of Cincinnati - Clermont College www.ucclermont.edu	
Biomedical Equipment Technician										●										
Bioscience Technician		●	●															●		
Cardiographic Technician							●				●	●								
Community Health Worker						●														
Medical/Clinical Laboratory Technician							●		●	●	●	●	●	●			●	●	●	
Dental Assistant		●														●				
Dental Hygienist		●	●																●	
EMT		●	●	●	●			●		●	●	●	●			●		●		
Health Facilities Leadership												●								
Health Science Technology	●	●	●	●	●	●		●	●	●	●		●				●	●	●	
Human Services		●	●	●	●	●		●	●	●	●		●				●	●	●	
Massage Therapist					●			●												
Medical Admissions Clerk	●	●	●	●		●		●	●	●	●	●	●	●			●	●	●	
Medical Assistant	●	●	●	●	●	●	●	●	●	●	●	●	●	●			●	●	●	
Medical Coding/ Billing & Insurance	●	●	●	●	●	●		●	●	●	●	●	●	●			●	●	●	
Medical Secretary/ Office Assistant	●	●	●	●	●	●		●	●	●	●	●	●	●			●	●	●	
Medical Transcriptionist		●	●	●							●	●	●	●			●	●	●	
Nuclear Medicine Technology/Computed Tomography						●									●					
Nurse - LPN	●	●	●	●	●	●	●	●	●	●	●	●	●	●			●	●	●	
Nurse - RN	●	●	●	●	●	●	●	●	●	●	●	●	●	●	●	●	●	●	●	
Nurse Assistant/Nurse Aide	●	●	●	●	●	●	●	●	●	●	●	●	●	●	●	●	●	●	●	
Occupational Therapy Assistant/Pre-OT									●	●							●	●	●	
Orthotic and Prosthetic Technology			●																	
Paramedic			●		●					●	●	●	●		●					
Personal Trainer/Pre-Athletic Trainer																	●		●	
Pharmacy Technician/Assistant							●		●				●							
Phlebotomist	●	●			●			●		●	●	●	●		●		●			
Physical Therapy Assistant									●		●		●		●	●			●	
Physician Office Laboratory Assistant						●														
Radiographic Technologist	●	●	●	●	●	●			●	●	●	●	●	●	●	●		●	●	
Respiratory Therapist	●	●	●	●					●	●	●	●	●	●	●	●	●	●	●	
Sonographer				●	●							●				●	●			
Surgical Technologist	●		●		●	●		●	●	●		●	●	●	●	●	●			●
Telehealth Technician Assistant															●					